



Halogen FastFit

Hi-Brite 7017G 750W 80V FastFit

Halogen FastFit lamps are replaced in seconds - thanks to the specially designed base. The compact filament ensures high beam intensity, while the shock-resistant design allows easy handling and reliable use in moving head systems. In addition, the highly innovative P3 technology allows use at higher temperatures, which further extends lifetime and consistency of light output. P3 technology also allows the lamp to be used in any burning position and enables more compact designs of fixtures. And because the FastFit design is also applied to Philips MSR/MSD Gold™ lamps, switching lamp technologies is also quick and easy.

Product data

• General Characteristics

Philips Code	7017G
ANSI Code	-
System Description	P3 Technology
Cap-Base	PGJX50
Bulb Finish	Clear
Filament Shape	Bi-Plane
Operating Position	any
Main Application	Entertainment
Life to 50% failures	300 hr

• Light Technical Characteristics

Color Temperature	3250 K
Technical	
Luminous Flux Lamp	22500 Lm

• Electrical Characteristics

Lamp Wattage	750 W
Voltage	80 V
Dimmable	Yes
Rapid Acting HBC	16 V
Fuse	

• Luminaire Design Requirements

Pinch Temperature	500 (max) C
-------------------	-------------

• Product Dimensions

Overall Length C	125 (max) mm
Diameter D	19 (max) mm
Overall Width E	41 (max) mm
Light Center Length	65 mm
L	
Filament Dimensions (WxH) [mm]	8.5x9.5
Filament Height H	10 mm
Filament Length W	8.5 mm

• Product Data

Order code	924576828928
Full product code	924576828928
Full product name	Hi-Brite 7017G 750W 80V FastFit
Order product name	Hi-Brite 7017G 750W 80V FastFit
Pieces per pack	1
Packing configuration	10
Packs per outerbox	10
Bar code on pack - EAN1	8711500507952
Bar code on outerbox - EAN3	8711500507969
Logistic code(s) - 12NC	924576828928
Net weight per piece	0.133 kg

PHILIPS

Dimensional drawing

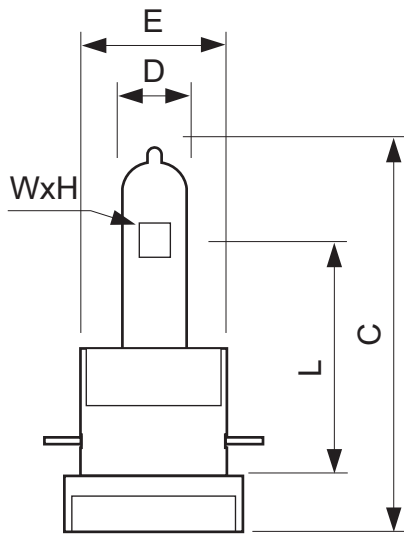

Hi-Brite 7017G 750W 80V FastFit

Product	C (Max)	D (Max)	E (Max)	H (Norm)	L (Norm)	W (Norm)
Hi-Brite 7017G 750W PGJX50 80V FastFit	125	19	41	10	65	8.5

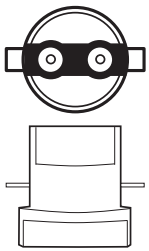

PGJX50



© 2014 Koninklijke Philips N.V. (Royal Philips)
All rights reserved.

Specifications are subject to change without notice. Trademarks are the property of Koninklijke Philips N.V. (Royal Philips) or their respective owners.

www.philips.com/lighting

2014, October 31
data subject to change