

EMERGENCY ESCAPE LIGHTING

LOVATO II

MATERIALS:

White, grey or black polycarbonate body

MOUNTING:

Surface (ceiling)

POWER SUPPLY:

Self contained – 220 - 240VAC/50 - 60Hz

Central battery – 220 - 240VAC/50 - 60Hz; 176 - 275VDC

Central battery FZLV – 24VDC

LIGHT SOURCE:

1W, 2W, 3W power LED

Optics

C - corridor

R - escape route

O - open area

U - universal

A - asymmetric

CHARGING:

BASIC: max. 24h

STANDARD: max. 24h

PREMIUM: max. 12h; energy-saving electronic charger

AUTONOMY AND BATTERIES:

BASIC: 1h or 3h, Ni-Cd 3,6V batteries

STANDARD: 1h or 3h, Ni-Cd 3,6V batteries

PREMIUM: 1h or 3h, LiFePO₄ 6,4V batteries

INSULATION CLASS:

II or III

IP RATING:

IP41

AMBIENT TEMPERATURE:

Self-contained:

t_a: 0°C ÷ 40°C

CB:

t_a: 0°C ÷ 50°C

OPTIONS:

SE – non maintained

SA – maintained (with an option of connecting as non-maintained)

AT – autotest

PT – manual test button

RU – Rubic UNA central monitoring

RW – RUBIC UNA Wireless central monitoring

FZLV – central battery FZLV 24VDC

CB – central battery

ADDITIONAL INFORMATION:

LED indicator signalizes mains power supply and battery charge

Deep discharge protection

III class of insulation of FZLV version



DIMENSIONS (mm):

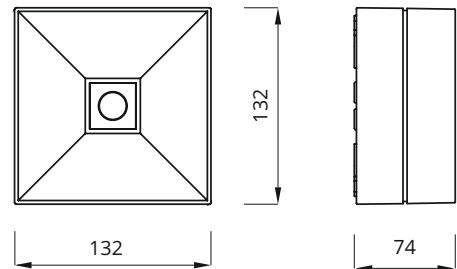
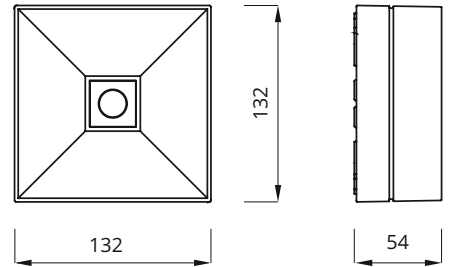

220-240V AC 50-60Hz	176-275V DC	24V DC	LED	IP41	
		CE	Ni-Cd	LiFePO ₄	



KM 618355
BS-EN 60598-2-22

EMERGENCY ESCAPE LIGHTING

SELF-CONTAINED CONFIGURATION:

CODE		POWER	MODULE	AUTONOMY [h]		MODE	OPTIONS	COLOR		
BASIC										
LV2R LB2R	LV2U LB2U	LV2O LB2O	LV2C LB2C	LV2A LB2A	1W	E	1 3	SE	PT X	WH GR BL
STANDARD										
LV2R LB2R	LV2U LB2U	LV2O LB2O	LV2C LB2C	LV2A LB2A	1W	C	1 3	SA	PT X	WH GR BL
					2W	C	1 3	SA	PT X	WH GR BL
					3W	C	1 3	SA	PT X	WH GR BL
PREMIUM										
LV2R LB2R	LV2U LB2U	LV2O LB2O	LV2C LB2C	LV2A LB2A	1W	B	1 3	SA	AT RU RW	WH GR BL
					2W	B	1 3	SA	AT RU RW	WH GR BL
					3W	B	1 3	SA	AT RU RW	WH GR BL

OUTPUT IN EMERGENCY MODE

POWER	OUTPUT [lm]				
	LV2R	LV2U	LV2O	LV2C	LV2A
BASIC					
1W	140	130	130	140	130
STANDARD					
1W	140	130	130	140	130
2W	240	240	240	240	250
3W	340	350	350	330	345
PREMIUM					
1W	140	140	140	150	140
2W	250	270	270	240	270
3W	370	390	390	360	370

CENTRAL BATTERY CONFIGURATION - NON-ADDRESSABLE

CODE		POWER	MODULE	SYSTEM	OPTIONS	COLOR			
LV2R LB2R	LV2U LB2U	LV2O LB2O	LV2C LB2C	LV2A LB2A	1W	F	CB	CBS X	WH GR BL
					2W	F	CB	CBS X	WH GR BL
					3W	F	CB	CBS X	WH GR BL

OUTPUT IN EMERGENCY MODE

POWER	OUTPUT [lm]				
	LV2R	LV2U	LV2O	LV2C	LV2A
1W	140	140	140	150	140
2W	250	270	270	240	270
3W	370	390	390	360	370

CENTRAL BATTERY CONFIGURATION - ADDRESSABLE:

CODE		POWER	MODULE	SYSTEM	OPTIONS	COLOR			
LV2R LB2R	LV2U LB2U	LV2O LB2O	LV2C LB2C	LV2A LB2A	1W	Z	CB	ADE ADP	WH GR BL
					2W	Z	CB	ADE ADP	WH GR BL
					3W	Z	CB	ADE ADP	WH GR BL

OUTPUT IN EMERGENCY MODE

POWER	OUTPUT [lm]				
	LV2R	LV2U	LV2O	LV2C	LV2A
1W	140	140	140	150	140
2W	250	270	270	240	270
3W	370	390	390	360	370

FZLV SYSTEM CONFIGURATION:

CODE		POWER	SYSTEM	COLOR			
LV2R LB2R	LV2U LB2U	LV2O LB2O	LV2C LB2C	LV2A LB2A	1W	FZLV	WH GR BL
					2W	FZLV	WH GR BL
					3W	FZLV	WH GR BL

OUTPUT IN EMERGENCY MODE

POWER	OUTPUT [lm]				
	LV2R	LV2U	LV2O	LV2C	LV2A
1W	140	140	140	150	140
2W	250	270	270	240	270
3W	370	390	390	360	370

Output in emergency mode of LB2 is the same like LV2.

LEGEND:

- LV2R – fixture Lovato II with optics for escape route
- LV2U – fixture Lovato II with universal optics
- LV2O – fixture Lovato II with optics for open area
- LV2C – fixture Lovato II with optics for corridor
- LV2A – fixture Lovato II with asymmetric optics
- LB2R – fixture Lovato II with large Box and optics for escape route
- LB2U – fixture Lovato II with large Box and universal optics
- LB2O – fixture Lovato II with large Box and optics for open area
- LB2C – fixture Lovato II with large Box and optics for corridor
- LB2A – fixture Lovato II with large Box and asymmetric optics
- E – electronic gear for BASIC self-contained fittings
- C – electronic gear for STANDARD self-contained fittings
- B – electronic gear for PREMIUM self-contained fittings
- F – electronic gear for central battery fittings
- Z – electronic gear for addressable central battery fittings
- SE – non maintained
- SA – maintained (with an option of connecting as non-maintained)
- PT – manual test button
- X – fitting without additional options
- AT – autotest
- RU – Rubic UNA central monitoring
- RW – RUBIC UNA Wireless central monitoring
- FZLV – central battery FZLV 24 VDC
- CB – central battery version
- CBS – central battery for circuit monitoring
- ADP – central battery with ADP address module – SMART technology
- ADE – central battery with ADE address module
- WH – white color
- GR – grey color
- BL – black color

INFORMATION FOR READERS

Photometry of LOVATO 2 – LV2C, LV2R, LV2O, LV2U, LV2A

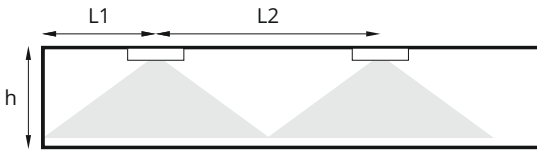

L1 – distance from the wall to the first fixture
L2 – distance between fixtures
h – height of the ceiling



LV2C - with optics for corridor

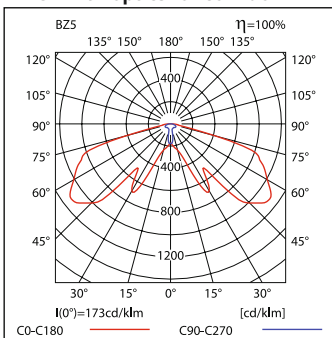

LV2C 1W (150lm) min.1lx

h [m]	L1	L2
2,50	5,5	15,0
3,00	5,5	16,0
3,50	5,0	16,0
4,00	5,0	16,5
4,50	5,0	16,5
5,00	4,5	16,5

LV2C 2W (240lm) min.1lx

h [m]	L1	L2
2,50	6,5	17,5
3,00	7,0	19,0
3,50	7,0	19,0
4,00	7,0	19,5
4,50	7,0	19,5
5,00	6,5	20,0
6,00	6,5	20,5
7,00	6,5	21,0

LV2C 3W (360lm) min.1lx

h [m]	L1	L2
2,50	7,5	19,0
3,00	8,0	20,5
3,50	8,5	21,0
4,00	9,0	23,0
4,50	9,0	24,0
5,00	9,5	25,0
6,00	10,0	26,0
7,00	10,0	28,0
8,00	9,5	29,0

LV2R – with optics for escape route

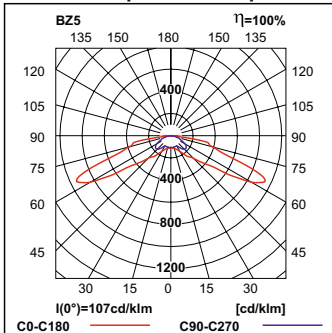

LV2R 1W (140lm) min. 1lx

h [m]	L1	L2
2,50	6,0	14,0
3,00	6,5	15,5
3,50	7,0	17,0
4,00	6,5	18,0

LV2R 2W (250lm) min. 1lx

h [m]	L1	L2
2,50	7,0	16,0
3,00	7,5	17,5
3,50	8,0	19,0
4,00	9,0	21,0
4,50	9,5	22,5
5,00	9,5	24,0
6,00	9,5	25,0

LV2R 3W (370lm) min. 1lx

h [m]	L1	L2
2,50	7,5	17,0
3,00	8,0	18,5
3,50	9,0	20,0
4,00	9,5	22,0
4,50	10,0	23,5
5,00	10,5	25,0
6,00	10,5	27,0

LV2O – with optics for open area

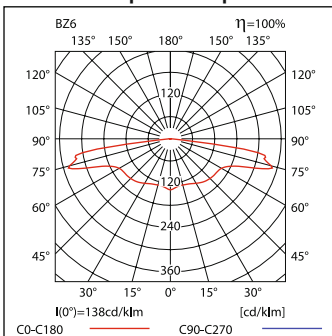

LV2O 1W (140lm) min. 0,5lx

h [m]	L1	L2
2,50	3,0	11,0
3,00	2,5	11,5
3,50	2,5	13,0
4,00	2,5	12,5
4,50	2,5	12,5
5,00	2,0	11,0
6,00	1,5	10,5

LV2O 2W (270lm) min. 0,5lx

h [m]	L1	L2
2,50	5,0	16,5
3,00	5,0	16,5
3,50	4,5	17,0
4,00	4,0	17,0
4,50	4,0	17,0
5,00	3,5	17,0
6,00	3,5	16,0

LV2O 3W (390lm) min. 0,5lx

h [m]	L1	L2
2,50	5,0	18,0
3,00	5,0	18,0
3,50	4,5	18,0
4,00	4,5	18,5
4,50	4,0	20,0
5,00	3,5	20,0
6,00	3,5	19,5
7,00	4,0	18,5
8,00	4,0	18,0

